

TS-548 Handsworth Road - Sheffield Parkway - West Bound Slip Road.

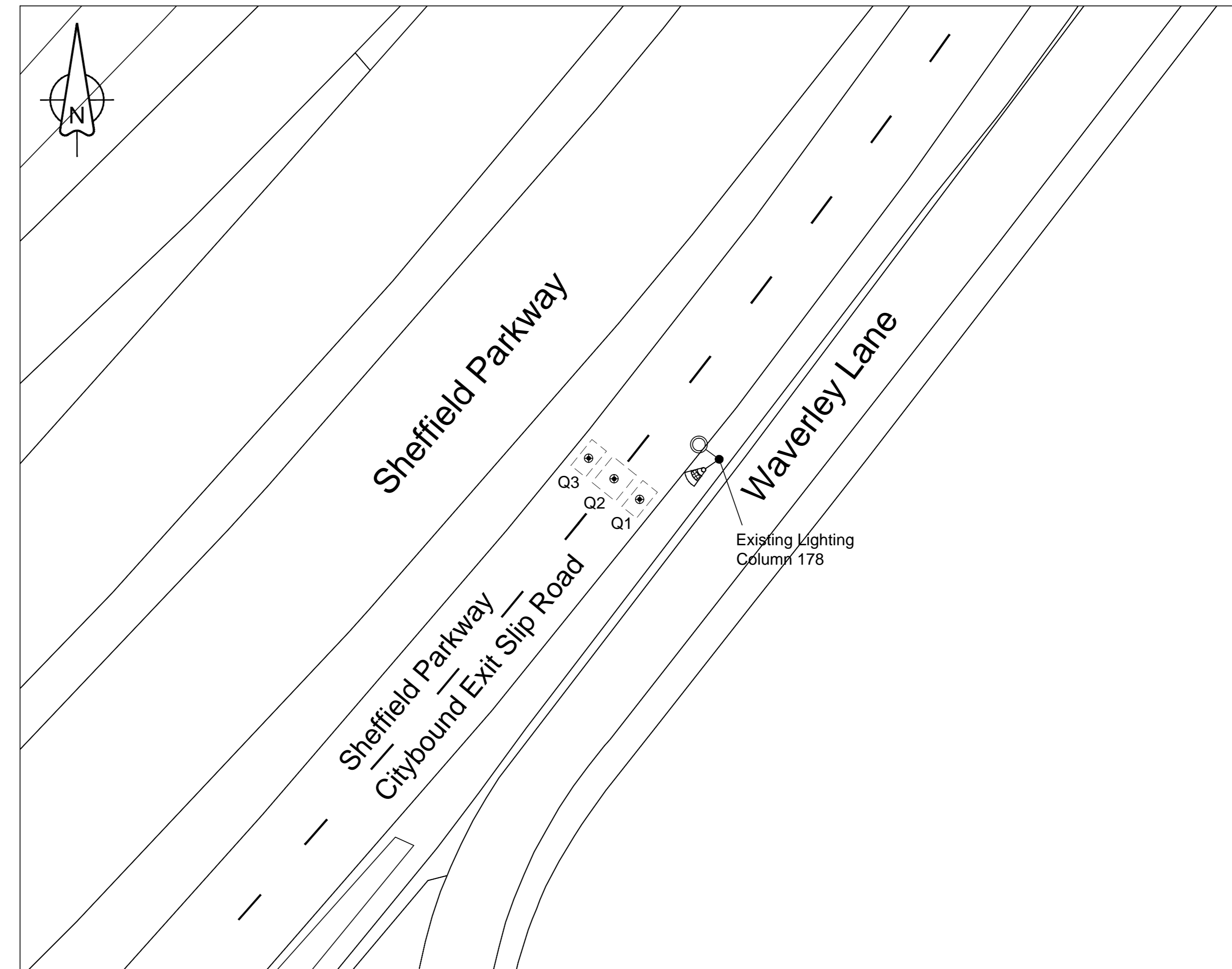

Count Site 1 - Sheffield Parkway - West Bound Slip Road

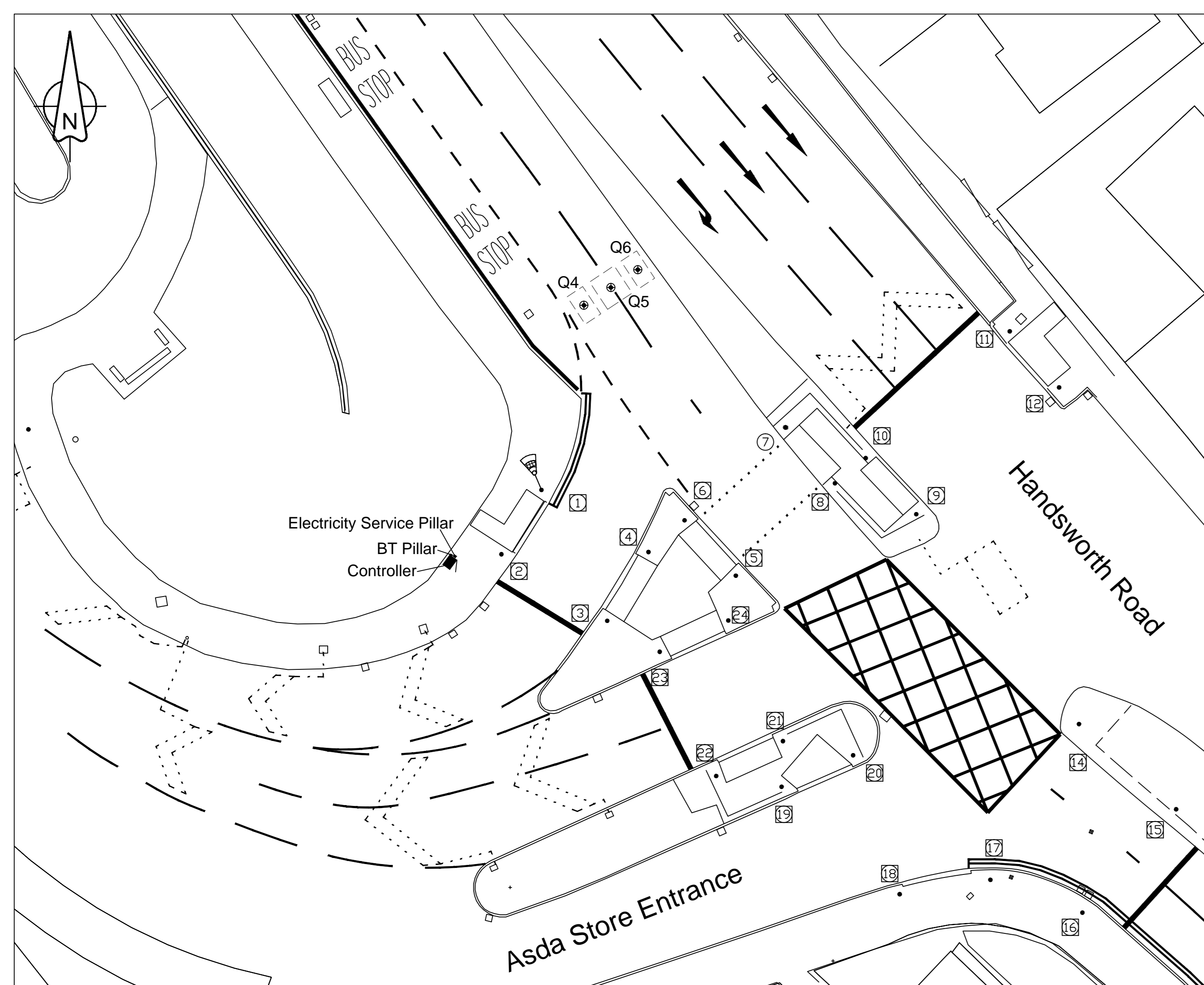

Count Site 2 - Handsworth Road.

**STREET FURNITURE REQUIREMENTS**

Pole No	Phase	Head or P-B Type	TRO Box Sign	Brackets	Ext Bracket	TRO Sign
1	A	1P	-	MEDIUM	-	-
-	A	1P#	-	MEDIUM	-	-
-	-	PEC	-	-	-	-
-	-	MESH	-	-	-	-
-	-	CV-AP	-	-	-	-
2	A	1P	-	MEDIUM	-	-
-	A	1P#	-	MEDIUM	-	-
-	-	CV-AP	-	-	-	-
3	-	CV-FR	-	-	-	-

# - Denotes 'high level' signal head  
 +- Denotes 'Narrow Angle' Trafficcam unit  
 - - Denotes 'Wide Angle' Trafficcam unit  
 T - Denotes 'Tactile' unit fitted to this push button unit  
 CV-AP - ClearView Magnetometer Access Point  
 CV-FR - ClearView Flex Repeater

**POLE DETAILS**

Pole No	Type	Offset From Kerb*
1	TP	0.7 METRES
2	TP	0.7 METRES
3	SP	7.5 METRES

Key  
 Pole Type refers to the type of signal pole used.  
 i.e. SP - Standard signal pole  
 TP - Standard tele pole  
 \* - measured from face of kerb to face of pole.

All poles to meet current British Standards & be steel, hot-dipped galvanised & powder coated as set out in Appendix 12/5 section 2.8.

**EXTERNAL AND PUSH BUTTON INPUTS**

ID	Detector Label	Virtual Zone	Distance From (M)
-	Q1	-	161*
-	Q2	-	161*
-	Q3	-	161*
-	Q4	-	14#
-	Q5	-	14#
-	Q6	-	14#

\* measured from stop line to center of magnetometer  
 # measured from studs adjacent to pole 6 to center of magnetometer.

**ClearView Magnetometer equipment.**

The following new equipment will be installed on existing sites.  
 Handsworth Road - ASDA access.  
 Clearview Repeater to be mounted on Pole 1.  
 Sheffield Parkway Street Lighting Column 178.  
 Clearview Repeater.

**UTC Communications.**

- 32bit Chameleon
- 5 way Ethernet Switch
- New IDT IMESH Router and associated cables brackets and antenna.
- IDT IMESH Antenna and splitter to be mounted on existing IMESH router at CCTV camera installation.

**THIS IS AN ELV SITE.**

**KEY**

- 3 Aspect RAG Primary Signal Head with 'high level' 3 Aspect RAG Primary Signal Head
- Proposed Single Wireless Mesh Antenna
- Existing Single Wireless Mesh Antenna
- Clearview Access Point
- Clearview repeater
- Clearview flex repeater
- Existing Street Lighting Column
- Proposed Signal pole with retention socket
- Proposed signal pole number
- Existing signal pole number
- Existing CCTV Pole
- ELV signal controller with electricity supply pillar
- Proposed Magnetometer detector and detection zone
- Existing Presence or Queue loop
- Existing X, Y or Z loop
- Existing Stoplevel loop
- Cable box (450 x 450)
- 1 - way duct (1x100mm)
- 2 - way duct (2x100mm)

**Notes.**

- Pole numbers should be placed 2.0 m above ground level under the lower bracket of the signal head. They are to be seen approaching the installation.
- The controller shall be labelled according to the contract. This shall be applied at the top of the cabinet facing into the main road carriageway.
- Orientation of PDU's shall be in accordance with the drawing, generally 30° from parallel to the kerb.
- Signal heads to face the carriageway and be aligned to a distance of:  
 Primary's - 100m  
 Secondary's - 25m  
 to be aimed 1.5m above the carriageway, 1m from the offside of each lane. Signal heads will be side-mounted to meet SCC standard details for head clearances.
- Kerbside & On-crossing detectors to be setup with manufactures instructions and guidance in TR2506 & TR2507.
- For Residual Design Hazards, please refer to dwg no TS-208150-0017-03.

**For Tender**

Rev	Revision details	Chkd	Appd	Date
Drawn: S.J.S				Preliminary
Design: J.B				For comment
Chkd: J.B				For tender
Appd: H.S				For construction
Date: 11th January 2018				As constructed
				Other

Client:

Project Name: **Handsworth Road / Sheffield Parkway Ramp Metering**

Drawing Title: **Traffic Signals & Detection Proposals**

Original Drawing Size: A0 Dimensions: Scale: 1:200 Copyright © Amey

Drawing No: **TS-208150-0017-01** Rev